

## EDUCATION APPLICATION

### OASIS 7 (O7)

---



VIEW #1



## PLACE: OASIS

Oasis is a small area of retreat for individuals to rest, think, work, or quietly converse with others.

## PRIMARY INSIGHT: ENHANCE WELL-BEING

Connecting people to natural light, fresh air, and nature for moments of respite and rejuvenation enhances well-being.



VIEW #2



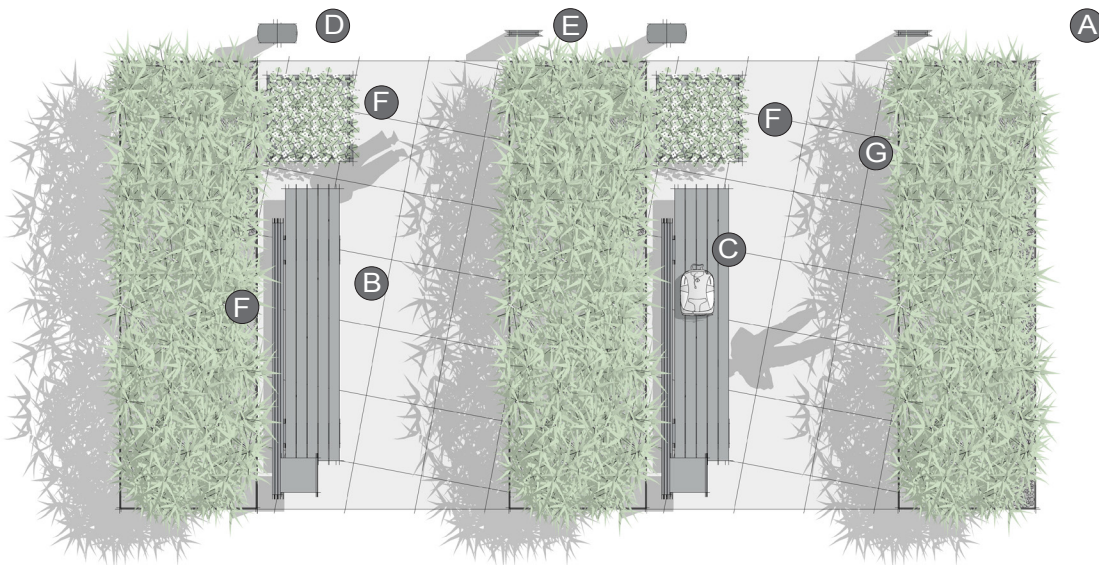

PLAN



ELEVATION

## ELEMENTS, ATTRIBUTES, AND USER EXPERIENCE

- A** An Oasis may be adjacent to a Plaza or strategically placed throughout the campus.
- B** The site is small and sheltered to minimize distractions.
- C** **MultipliCITY bench** offers ample seating and space for personal belongings during rejuvenating moments of respite or quiet conversation. A small cantilevered surface provides ergonomic arm support or space to work.
- D** **MultipliCITY path lighting** adds calming ambiance while increasing security.
- E** **Reeder illuminated sign** provides campus wide wayfinding and identification of available settings which eases navigation and reduces stress.
- F** **Sorella planters** offer a place for flowers which engage visual and olfactory senses enhancing the overall campus experience.
- G** Peripheral plantscaping creates a softened boundary and sense of place.

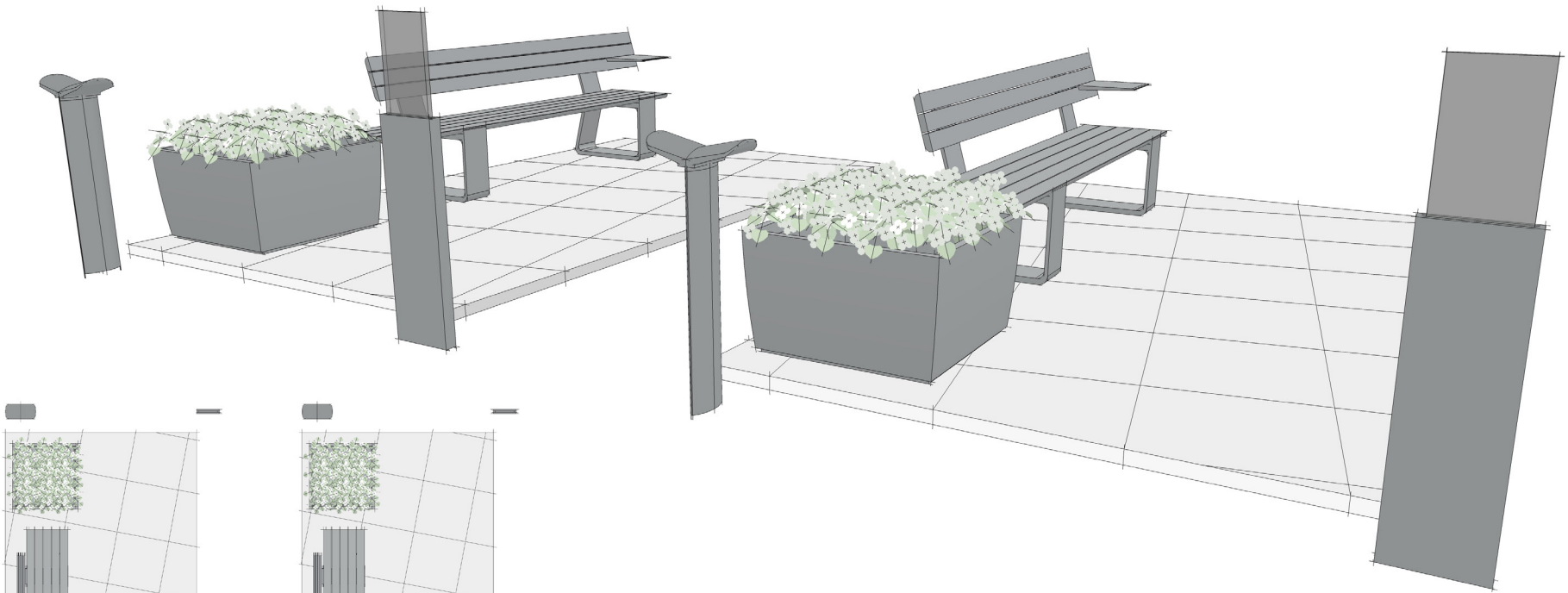

PERSPECTIVE

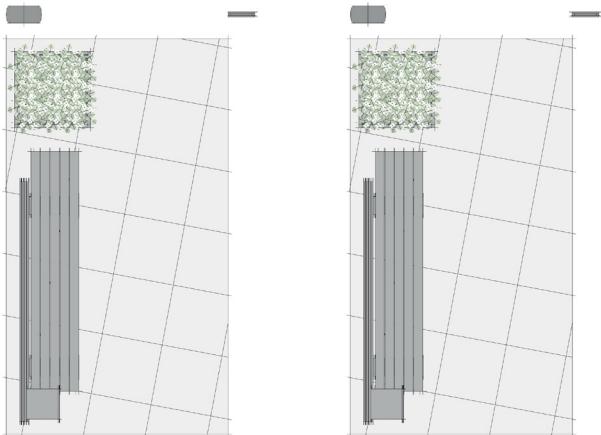

PLAN