



Place: Classroom

An outdoor classroom is an area designed to support groups as they gather to learn, present, and discuss.

Primary Insight: Encourage Active Learning

Well-designed environments can encourage a modern, active approach to education by supporting effective presentation, collaboration and socialization methods.



View 1

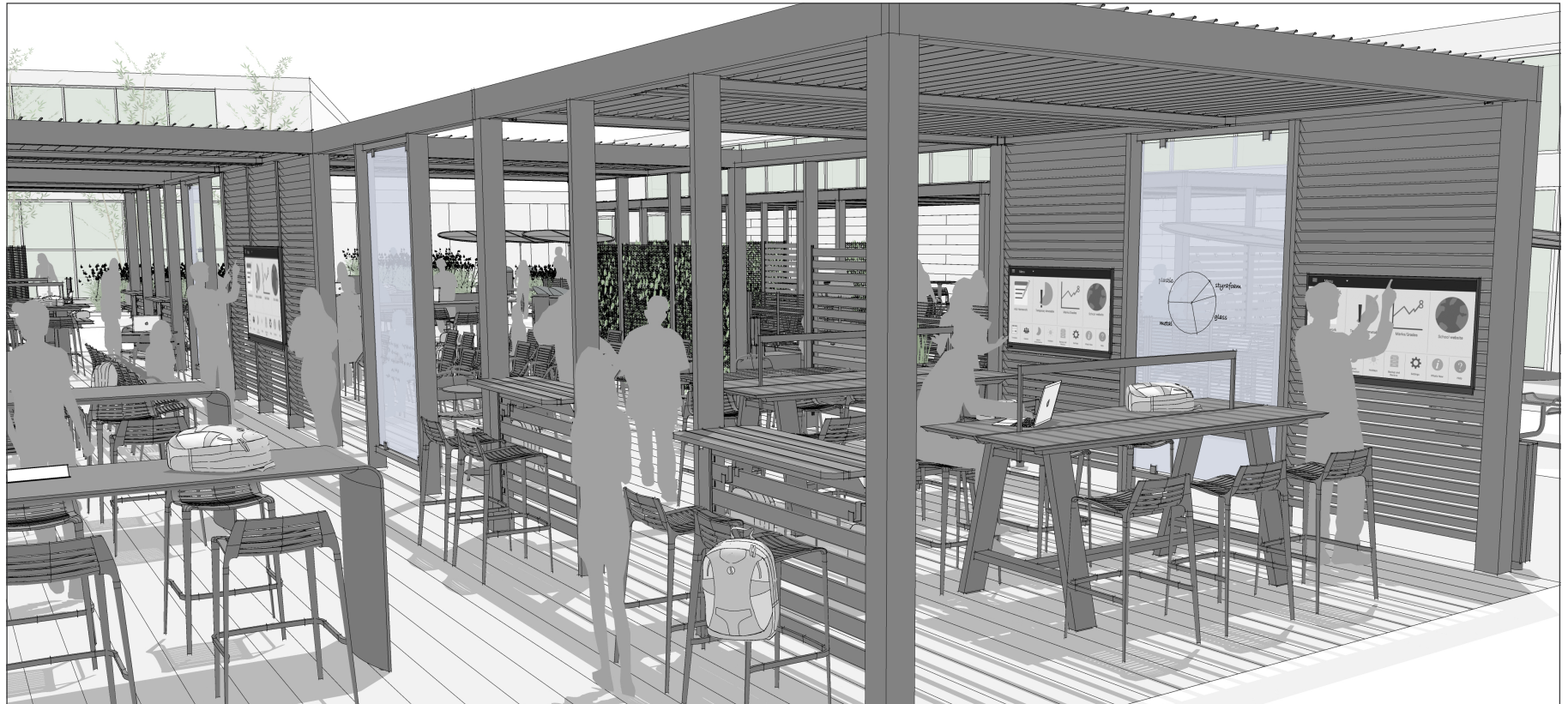

View 2



View 3

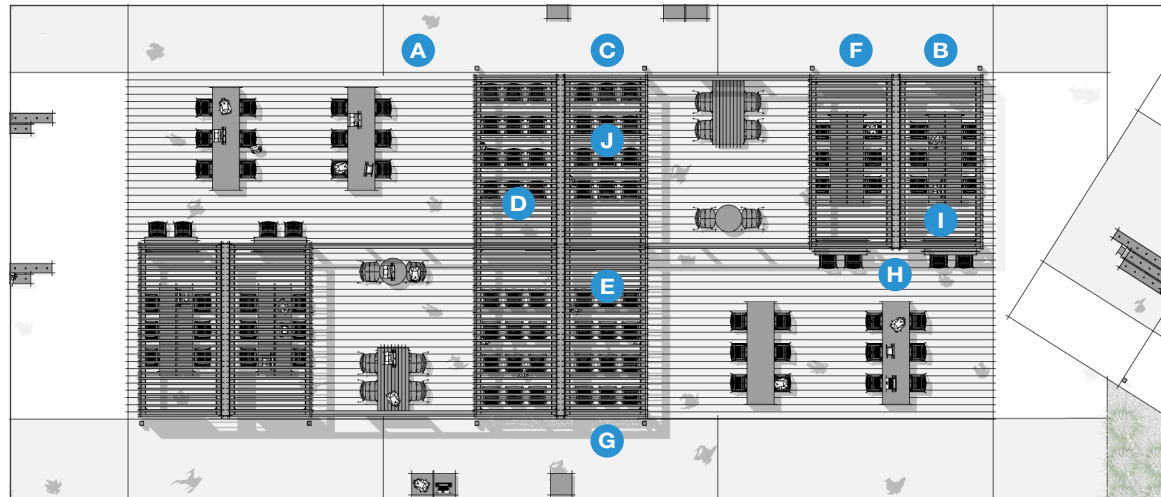

Plan

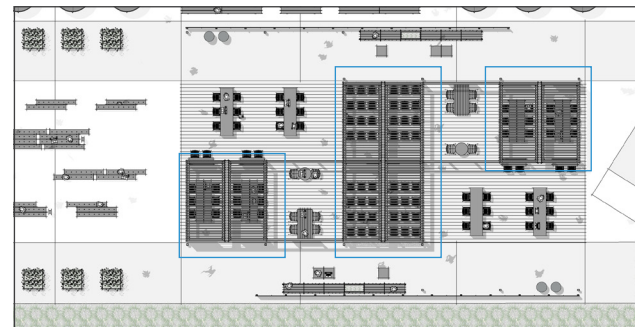

Key Plan

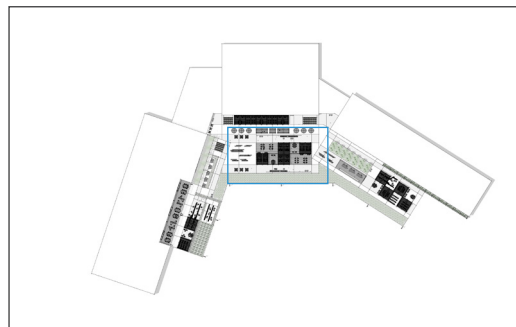

Site Map

Elements, Attributes, and User Experience

- A** Classroom layout supports lectures and group presentations.
- B** The furniture configurations encourage collaboration among multiple groups through face-to-face social interactions and support a variety of postures.
- C** *Upfit* adaptive structures create high performance learning settings by incorporating electricity to power lights, display monitors, and charging ports to stay connected, and support modern teaching tools while outdoors.
- D** *Upfit* louvered roof protects students from the elements while reducing glare on digital devices.
- E** *Upfit* louvered panels angle to shade interiors and maximize privacy.
- F** *Upfit* glass panels also act as markerboards to support collaborative learning and presentations.
- G** *Upfit* green wall panels create a soft natural boundary to the learning space
- H** *Upfit* inline tables attach to the structure to create working, reading, and perching spots.
- I** *Harvest tables* with *Chipman stools* support group based active learning.
- J** *Chipman chairs* create an efficient classroom layout.